

# Installation Instructions

## **Minerals/Silhouette Shower Trays**



# Before you Start



Please read these instructions fully in conjunction with all other installation instructions such as enclosures and waste units before starting.

Although these instructions are simple and comprehensive, we always recommend that a technically competent installer undertakes the installation.

Your shower tray has been manufactured to the highest quality standards. However, to ensure that you have received the correct product in the condition you expect, please undertake the following five basic preinstallation checks.

**DO NOT INSTALL IF NOT SATISFIED and contact your supplier.**

- 1 Check / measure that the shower tray received is the correct size and shape required.
- 2 Check that the shower tray is compatible with your chosen enclosure.
- 3 Check that the shower tray is the correct colour and finish required.
- 4 Check for any damages or marks on the surfaces.
- 5 Place the shower tray in a suitable area, level and pour water over the total surface area of the tray and check for adequate drainage.



**Note! Installation is acceptance of quality.**

## Installation Methods

Your shower tray **MUST** be installed in accordance with these instructions. These instructions relate to floor installation and the Suspended Floor section must also be applied if constructing a raised plinth.



**Note! We do not accept responsibility for any loss or damage resulting from failure to comply with installation instructions.**

## Important

Your shower tray **MUST** be stored in accordance with the labeling instructions attached to the outer packaging.

If you intend to install this in conjunction with a steam unit, you **MUST** ensure that the steam outlet is at a minimum of 350mm from the top of the tray.

When handling your shower tray take care not to damage the bottom edges and when installing / tiling and finishing take particular care to protect the visible surfaces from impact or abrasion damages.



Dimensions are nominal and shown in millimeters unless otherwise stated.

## Safety Notes

Care **MUST** be taken when using sharp tools and when using power tools, ensure these are used safely and in accordance with all regulations.

Care **MUST** be taken when drilling or excavating into walls or floors to avoid hidden pipes or electrical cables.

Care **Must** be taken when lifting this heavy quality product and requires a minimum of 2-person lift at all times.

Appropriate PPE **MUST** be used at all times.

## Care & Use of Your Shower Tray

To assist the end user, these installation instructions **MUST** be retained and passed to the user for possible future reference.

Your shower tray can be easily maintained in an as near new condition for many years by following a simple cleaning procedure as follows:

It is normal for localized amounts of water to be retained on the shower tray surfaces after use due to surface tension on smooth, slate effect and especially Anti-Slip trays. This **MUST** be wiped dry immediately after use to prevent the build-up of sediments that could water mark the surface of both white and coloured shower trays.

The shower tray should be cleaned regularly with a simple mix of warm, soapy water only and dried with a soft cloth. Never, use scourers, abrasives, bleach or other chemical cleaners as these can damage and discolour the surface.

## Parts Supplied

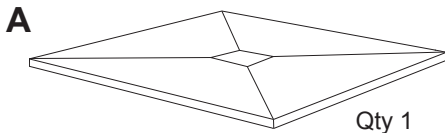

Shower Tray

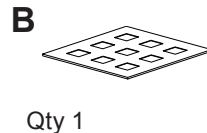

## Not Supplied



**Note: Waste Unit and coloured waste grilles (not supplied) are available seperatley)**

Steel Grille and 90mm bottle trap (order code X2X)

\* Shape of tray may differ from illustration

# Tools and Materials Required (not supplied)

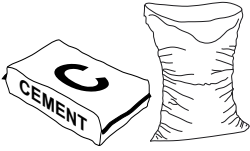

Cement and Fine Sand



Cement Additive Plasticiser

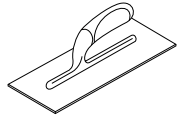

Trowel

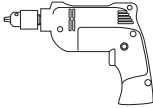

Power Drill

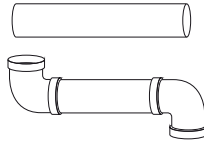

Plumbing Pipe and Fittings



Pencil

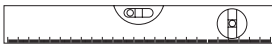

Spirit Level

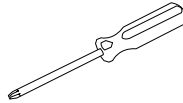

Cross-Head Screwdriver



Safety Eyewear

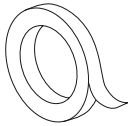

Masking Tape

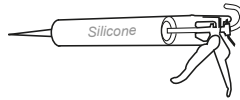

Silicone Sealant

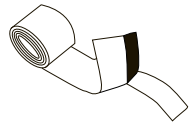

Flexi Seal Strip

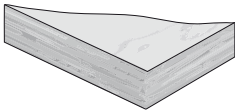

Plywood Board (min 18mm thick)



Floor Screws



Drill Bit

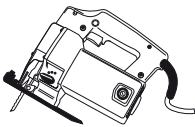

Jigsaw

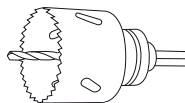

Hole Cutter

**NOTE!** Other tools and materials may be required depending on specific site requirements.

# Cutting the Shower Tray

Your shower tray offers the idea solution to many modern bathroom obstructions and dimensional limitations by enabling rapid adaptation to almost all situations.

**Note!** If your chosen tray has an off centre waste, the outlet must be positioned as close to the showering end as possible. The shower tray can be trimmed / cut to a wide variety of dimensions and shapes consequently, the following illustrations only show a small sample of the large number of the possible variations.

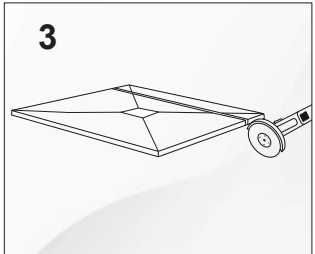
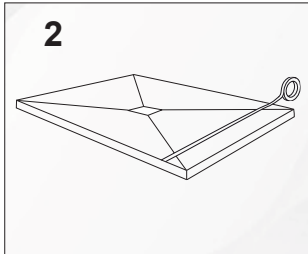
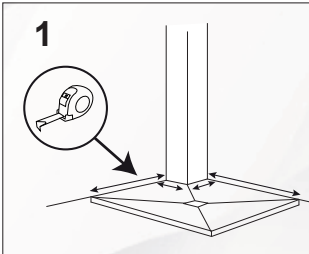
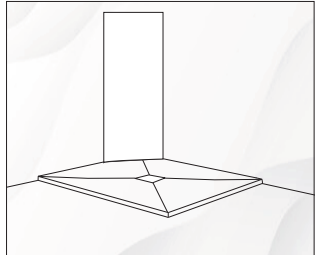
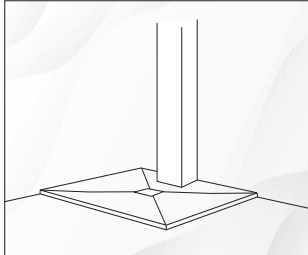
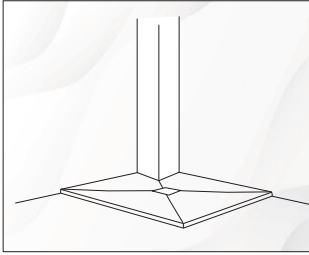

Carefully measure the available area for your intended shower tray.

**Note!** Ensure the outer tray dimensions remain suitable for your intended enclosure taking into account the reduced area that will result after any trimming or cutting of the shower tray.

With the shower tray upside down, mark the lines to be cut on the back of the tray using masking tape or other suitable marking method.

**Note!** Double check the area marked on the back face of the shower tray is correct when the tray is upright in-situ.

Carefully cut the marked area from the shower tray using a minimum of a four inch (approx 102mm) diamond blade (suitable for cutting stone) on an angle grinder or other suitable cutting tool.

**Note!** Take extra care not to damage the visible surfaces and do not force the rate of cutting. Only cut at the speed of the cutter to avoid damaging the tray.

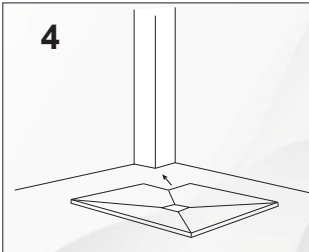

Test fit the shower tray in-situ making any further adjustments as necessary to ensure a snug fit.

Once you are satisfied, complete the installation by following the procedure for solid or suspended floors as appropriate.

**CAUTION!** Use safety eyewear and clothing at all times.

# Installation – Solid Floor

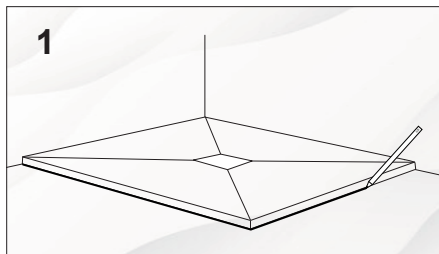

If your chosen tray has an off centre waste, the outlet must be positioned as close to the showering end as possible.  
Place the shower tray A in position and mark the perimeter and waste hole on the floor taking care not to mark the tray.

**Note! An area for access to connect plumbing after fitting will also be required.**

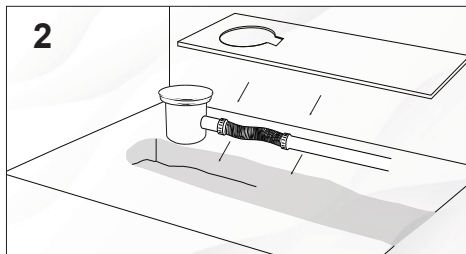

Form a trench in the floor to hold the piping (not supplied)

Install the trench in accordance with building regulations ensuring that sufficient drainage angle is achieved without the pipe sagging.

Blank off the trench level (using 18mm ply with waste outlet cut out hole) ensuring that the plumbing connections can be made once in position.

**Dry fit all items in-situ to ensure compatibility. DO NOT PROCEED IF NOT SATISFIED**

With some types of waste unit, it may be necessary to form a keyhole shaped cut-out in the ply using a jigsaw. This will make access to the waste unit easier during fitting.

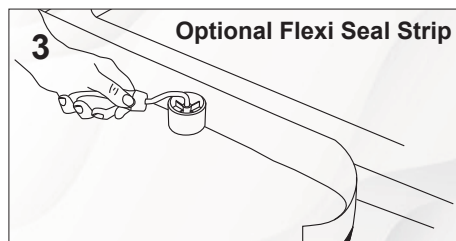

Some shower trays have a protective film (indicated by a label on the surface) which **MUST** now be removed. Undertake a final inspection of the shower tray at this stage.

**DO NOT PROCEED IF NOT SATISFIED.**

We recommend the use of the optional Flexi Seal Strip (not supplied) at this stage. Follow instructions supplied with product.

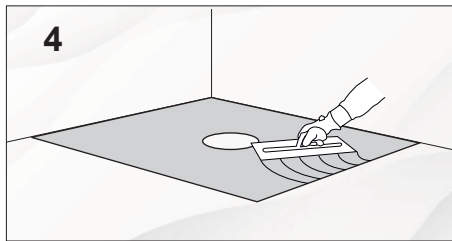

Mix fine sand, cement with a cement additive (plasticiser) in accordance with the manufacturers instructions to form a malleable mortar to cover the total area under the tray. Trowel to a thickness suitable to allow for correct leveling and **FULL** support of the shower tray

**Note! Silicone sealants, foams, mastics, installation compound adhesive or similar MUST NOT be used as a substitute for cement.**

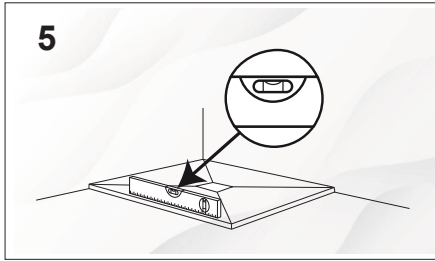

Place the shower tray (A) onto the wet cement ensuring that it is fully supported. Check the level of the top outer edges only as the shower tray has a built in fall for adequate drainage. Remove any excess cement and allow to fully set before continuing.

Connect the bottle trap in accordance with its installation instructions to the tray without fitting the chrome dome (if supplied) and attached down pipe.

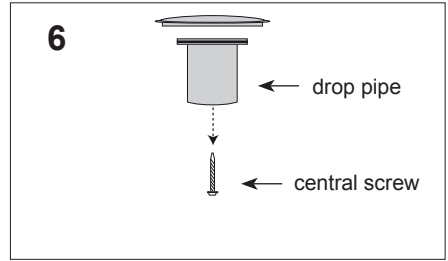

Once the cement has set, remove the drop pipe from chrome dome (if supplied) by unscrewing the central screw.

Discard the dome and screw but both the drop pipe and inner section **MUST** be retained for assembly.

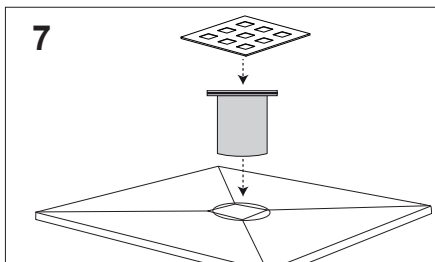

Assemble the inner section and drop pipe into the bottle trap, then place the grid in situ with the chosen surface uppermost.

The shower tray and all connections **MUST** now be checked for water tightness, flow and adequate drainage over the entire area. **DO NOT PROCEED IF NOT SATISFIED**

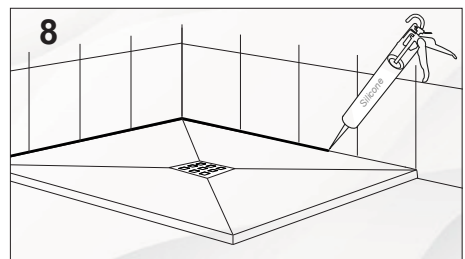

After all checks and adjustments, tile and then seal along the tiling line with silicone sealant

Note! On shower trays with a slate finish a thicker silicone bead will be require both along the tiles and the proposed enclosure outer edge due to the natural stone texture.

# Suspended Floor

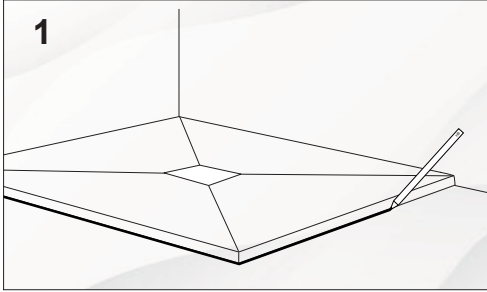

**If your chosen tray has an off centre waste, the outlet must be positioned as close to the showering end as possible.**

Place the shower tray A in position and mark the perimeter and the waste hole on the floor taking care not to mark the tray.

**Note! An area for access to connect plumbing after fitting will also be required.**

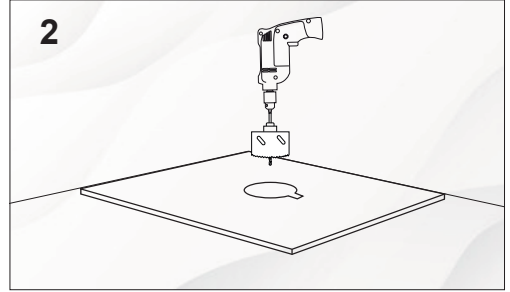

Mark the floor area (or larger) covered by the shower tray this MUST be removed and replaced with a single level piece of plywood (minimum 18mm thick). If it is unlevel, contains joints or is ridged.

Place the ply in position, ensuring the area is flat and level and rigid. With shower tray (A) placed on top mark the waste hole location.

Carefully remove the shower tray then use a suitable cutter to drill a hole in the floor/ply large enough to pass through the entire waste unit.

**With some types of waste unit, it may be necessary to form a keyhole shaped cut-out in the ply using a jigsaw. This will make access to the waste unit easier during fitting.**

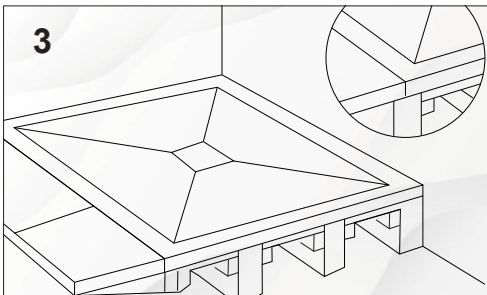

Alternatively the shower tray can be installed recessed into the floor onto joists to lower the tray if required. To achieve this remove the flooring, cut sections of 18mm ply to fit between the joists cut and screw the noggins along each side of the joists 18mm from the top. Then screw the sections of ply down onto the noggins level between the joists to form a flat rigid sub level floor.

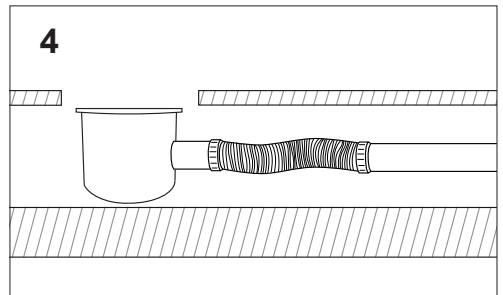

**Before proceeding dry fit all items in-situ to ensure compatibility.**

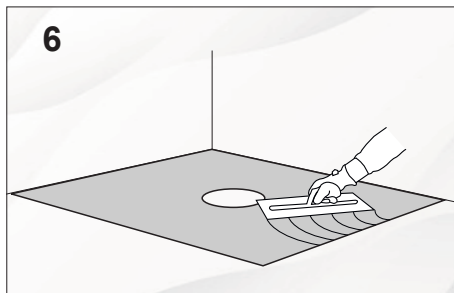
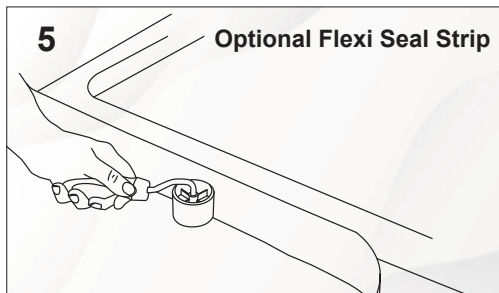

**Note! Some shower trays have a protective film (indicated by a label on the surface) which MUST now be removed. Undertake a final inspection of the shower tray at this stage. DO NOT PROCEED IF NOT SATISFIED.**

If fitting the optional Flexi Seal Strip (not supplied) follow the instructions later in this guide to attach the strip to the shower tray at this stage.

Mix fine sand, cement with a cement additive in accordance with the manufacturers instructions to a workable mix to cover the total area under the tray. Trowel to a thickness suitable to allow leveling and full support of the shower tray over the entire area.

**Note! Silicone sealants, foams, mastics, installation compound adhesive or similar MUST NOT be used as a substitute for cement.**

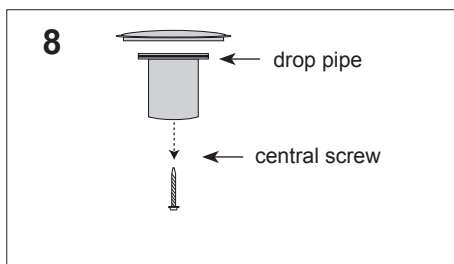
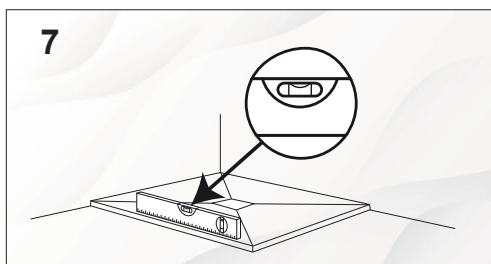

Place the shower tray A onto the wet cement ensuring that it is fully supported. Check the level of the top outer edges only as the shower tray has a built in fall for adequate drainage. Remove any excess cement and allow to fully set before continuing.

Connect the bottle trap in accordance with its installation instructions to the tray without fitting the chrome dome (if supplied) and attached drop pipe.

Once the cement has set, remove the drop pipe from the chrome dome (if supplied) by unscrewing the central screw. Discard the dome and screw but both the drop pipe and inner section **MUST** be retained for assembly.

# Installation – *Suspended Floor*

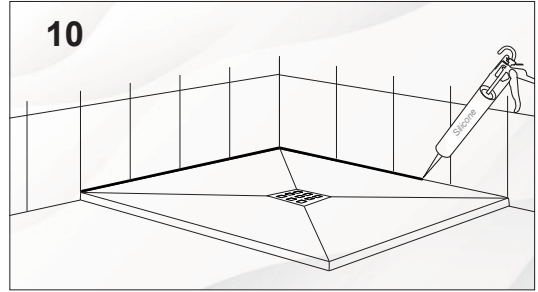
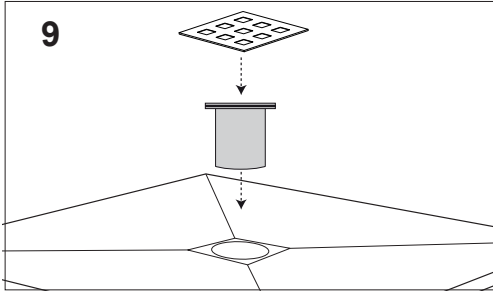

Assemble the inner section and drop pipe into the bottle trap, then place the grid in situ with the chosen surface uppermost.

The shower tray and all connections **MUST** now be checked for **WATER TIGHTNESS** flow and adequate **DRAINAGE** over the entire area. **DO NOT PROCEED IF NOT SATISFIED.**

After all checks and adjustments, tile and then seal along the tiling line with silicone sealant. If necessary, use a proprietary silicone cleaning solvent to the covered area only prior to application.

Note! On shower trays with a slate finish a thicker silicone bead will be required both along the tiles and the proposed enclosure outer edge due to the natural stone texture.

## Commonly Asked Questions & Troubleshooting

**Q The waste outlet in the shower tray is directly over an obstruction at floor level.**

**A** Consider raising the shower tray on a plinth.

**Q The shower tray will not fit the space available i.e. too large.**

**A** Your shower tray can be easily trimmed to fit or if it is only a small difference, consider recessing the edge of the tray into adjoining walls or using a smaller shower tray and enclosure.

**Q How much can I cut off the shower tray.**

**A** Provided the flow to waste is not obstructed and the dimensions remain suitable for your intended enclosure after tiling, the amount you can cut off is unlimited.

**Q The enclosure will not fit on the shower tray.**

**A** Check that you have the correct size / shape of enclosure for your shower tray and its adjustment is sufficient to permit it to fit when taking into account the loss of dimension from tiles or boarding.

**Q Water escapes / spills from a fitted Walk-in or frameless type enclosure.**

**A** It is normal for spillage to occur from these types of enclosures but can be limited by using a threshold seal and a hinged splash panel. Alternatively change to a fully framed enclosure.

**Q Water will not flow fast enough down the waste unit.**

**A** Check that the waste unit is correctly installed, and that the pipework has sufficient angle (Min 1 in 40). Also check the pipework is not kinked, obstructed or sagging causing an airlock.

**Q There is a bad smell coming from my waste outlet, what is causing this.**

A This is usually caused by failing to assemble the inner section and prop pipe into the bottle trap. Note! Also ensure that there is water in the inner section at all times.

**Q There is water retaining on the surfaces of the shower tray in general.**

A Check that the shower tray is level as it is normal for localized amounts of water to be retained on the shower tray surfaces after use due to surface tension.

**Q My shower tray is slippery underfoot.**

A When wet, the surface of the majority of shower trays will show an increase in the potential for slipping, this is particularly the case when soap, shampoo, bath oil, etc are used. Consider using Anti-Slip mats and or other safety aids.

**Q I have a coloured and or an Anti-Slip shower tray, will it mark or discolour.**

A Your shower tray can be easily maintained in an as near new condition for many years by following a simple cleaning procedure as outlined in the 'Care & Use of Your Shower Tray' section of these instructions.

**Q Can I simply Dot and Dab the cement underneath the shower Tray.**

A No, the mortar MUST cover the total area under the tray. The reason for this is ensure any localised failures from shrinkage is then supported by the surrounding cement.

**Q Why can't I use silicone or similar instead of cement.**

A The purpose of cement is to provide a load-bearing support interface between the base of the tray and the floor to also permit the tray to be levelled. Silicones and similar are elastomeric materials and will not meet the requirements.

**Q I have purchased legs for mounting the tray, can I use these.**

A Unfortunately no as the tray is not intended for use with Panel Riser Kits. If you need to raise the shower tray we would strongly advise constructing a plinth and installing in accordance with the Suspended Floor section.